



SITE PLAN FOR PROP. G+4 STD. RESIDENTIAL FLAT TYPE BLDG. OF 1) PRATIP KUMAR BARDHAN, S/O LT. SALIL CHANDRA BARDHAN, 2) SUCHARITA BOSE, W/O LT. PRASANTA KUMAR BOSE, 3) SUSMITA TALUKDAR, W/O LT. PRADIP KUMAR TALUKDAR, 4) SUNRITA RAYCHOWDHURY, W/O ASIT RAYCHOWDHURY, IN MOUZA - KANAINATSAL, J.L. NO.- 76, R.S. PLOT NO.- 111, 102/220, L.R. PLOT NO.- 111/726, L.R. KH. NO.- 355, AT MAHALLA KANAINATSAL NORTH, WARD NO.- 12, HOLDING NO. 23, P.S.- BARDHAMAN, DIST.- PURBA BARDHAMAN. UNDER BURDWAN MUNICIPALITY.

SCALE - 20'-0" = 1"

REFERENCE:-

AREA OF LAND = 4320 SFT.
NATURE OF LAND - "BASTU"
PROPERTY LINE SHOWN IN 
ROAD / PASSAGE SHOWN IN 
SEWER LINE SHOWN IN 

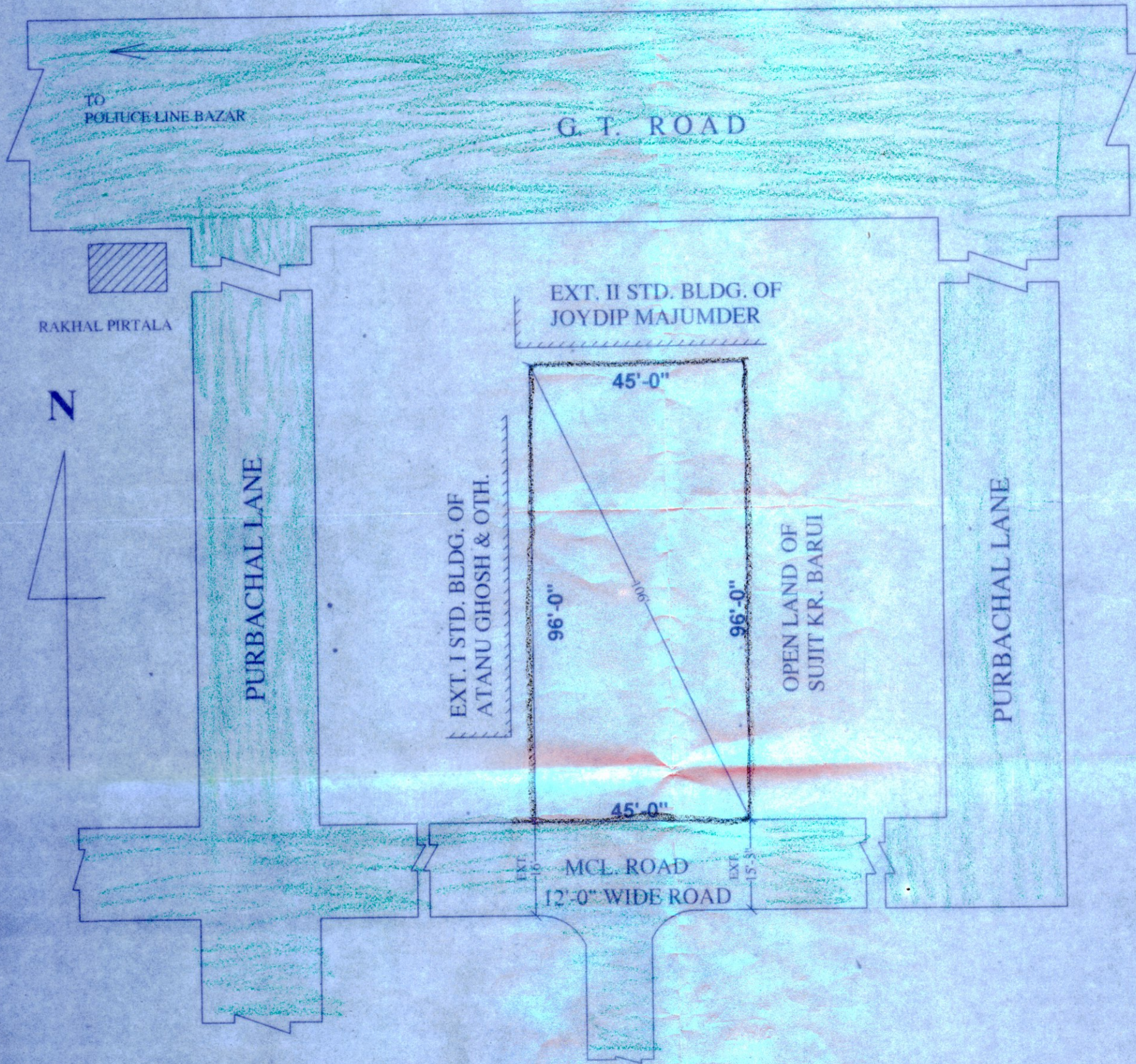

G. M. Shahidullah
12.10.18
Vice-Chairman
Burdwan Municipality

VICE CHAIRMAN

[Signature]
12/10/18
ENGINEER (B.M.)

[Signature]
12/10/18
HEALTH OFFICER

Pratip Kumar Bardhan
Sucharita Bose
Susmita Talukdar
Sunrita Ray Chowdhury
OWNER

[Signature]
DRAWN BY:-